

Fitting Guide

Mirror Shield FMX/XB (MS037)



IMPORTANT

Ensure vehicle is parked with handbrake applied and engine off before fitting this item.

Do not use power tools

Step 1.

Fix the clamp assemblies as shown in the exploded image, ensuring they do not move on their own but so that you can still move the clamps to find the desired position.

Step 2.

Place the MirrorShield onto the bolt fixings and line up with the wing mirror, sliding the clamps into the correct position.

Step 3.

Remove the MirrorShield and fully tighten clamps ensuring they do not move from the correct position.

Step 4.

Place the MirrorShield onto the fixed clamps, slide the bolt cover plate over the bolts, add the washers and spring washers. finally fully tighten on the dome head nyloc nuts securing the Mirror Shield.

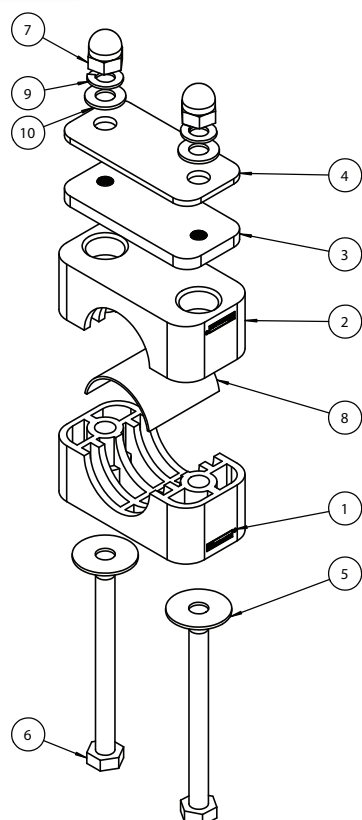

ITEM NO.	DESCRIPTION	QTY. Per Assembly
1	Clamp	1
2	Clamp	1
3	Threaded Bolt Plate	1
4	Cover Plate	1
5	M6x20_Washer	2
6	M6x60_Bolt	2
7	M6_Dome Head Nyloc Nut	2
8	Rubber Insert	1
9	M6_SPRING WASHER	2
10	M6X11_WASHER	2

If in doubt please contact
our team on
+44 (0) 1449 744174
or email
sales@kudauk.ltd.uk