

# KINSHOFER Rotator Line

## Product Features

**KINSHOFER** manufactures rotators for truck loaders, excavators and logging operations. Years of experience in designing rotators and hydraulic load handling equipment guarantee high efficiency, long lasting rotators, specially tailored to meet your requirements.

The gear-type design ensures a very compact and powerful rotator. The precision control and braking ability is especially appreciated by operators. A grapple does not rotate unexpectedly when digging, even under maximum load, and there is no need for stability compensation when handling longer lengths of timber... These are only some of the many working situations where operators appreciate the advantages of using **KINSHOFER** rotators.

**KINSHOFER Rotators are the solution.**



### Features of KINSHOFER Rotators

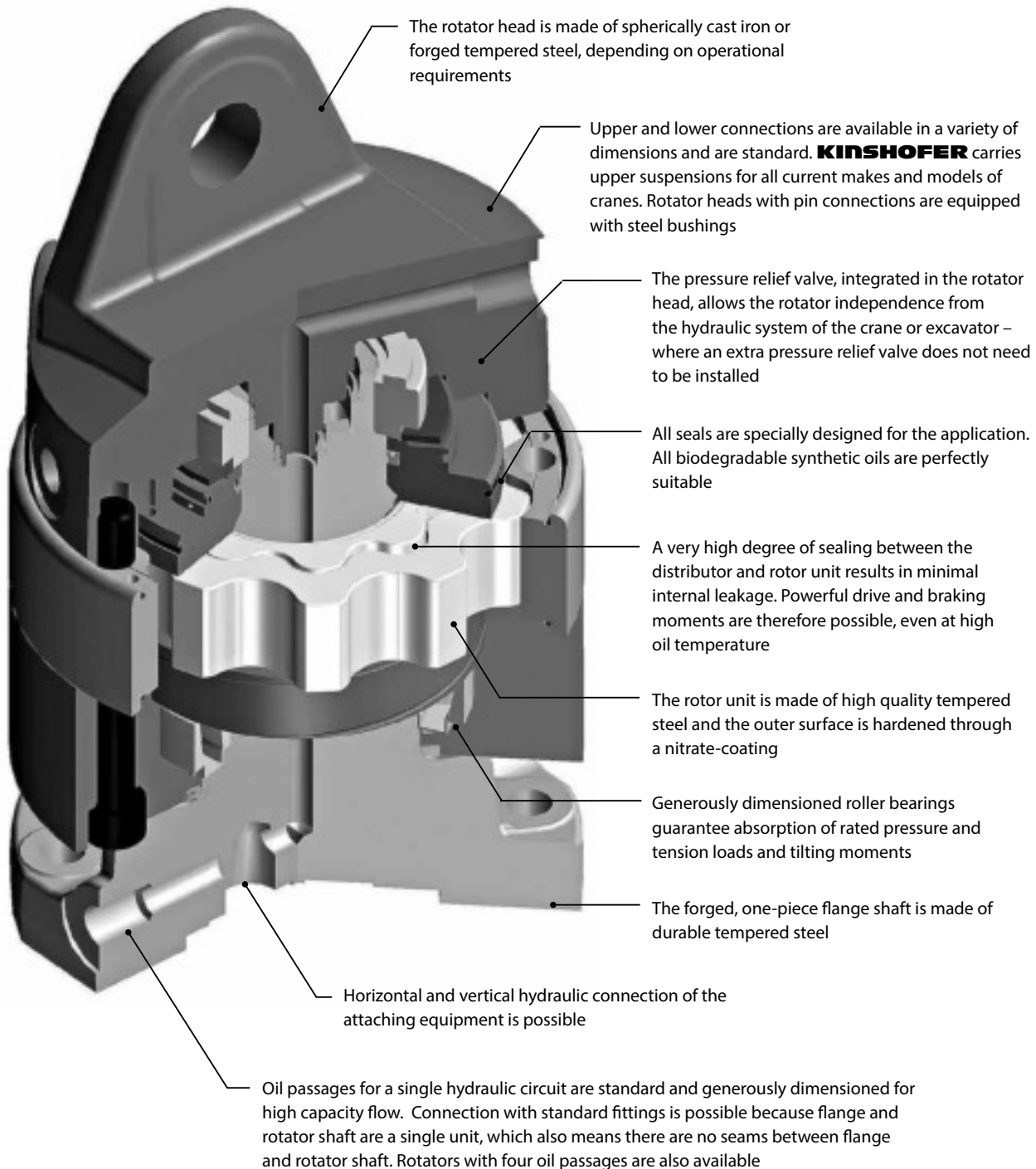

## KINSHOFER Gear Type Rotator with Shaft up to 3000 kg Load Capacity (incl. Fittings)

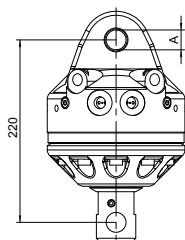

KM 03 S

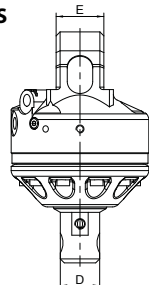

Type

KM 03 S

Load capacity  
(kg)

3000

Shaft Ø D  
(mm)

49.5

Upper connection  
(Width E x Pin-Ø A)  
(mm)

60 x 25

Torque  
(Nm)

450

Moment of deflection  
max.  
(Nm)

1750

Self weight  
(kg)

24



KM 03 S

Operating pressure:

32 MPa (320 bar)

Pump capacity:

25 - 60 l/min

Hydraulic coupling - in:

G 3/8"

Hydraulic coupling - out:

G 1/4"

## KINSHOFER Gear Type Rotator with Shaft up to 4500 kg Load Capacity (incl. Fittings)

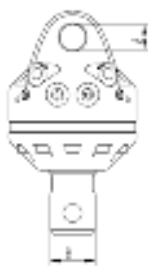

KM 04 S



Type

KM 04 S59-30

Load capacity  
(kg)

4500

Shaft Ø D  
(mm)

59

Upper connection  
(Width E x Pin-Ø A)  
(mm)

84 x 30

Torque  
(Nm)

850

Moment of deflection  
max.  
(Nm)

3000

Self weight  
(kg)

26

KM 04 S

4500

62

84 x 30

850

3000

26

KM 04 S63-30

4500

63

84 x 30

850

3000

26

KM 04 S68-30

4500

68

84 x 30

850

3000

26

KM 04 S68-30US\*

4500

68

84 x 30

1000

4500

28

KM 04 S69-30

4500

69

84 x 30

850

3000

26

\* steel motor-head



KM 04 S69-30

Operating pressure:

20 - 37 MPa (200 - 370 bar)

Pump capacity:

25 - 60 l/min

Hydraulic couplings:

M 18 x 1,5

! Pump capacity/Operating pressure  
> 40 l/min / 200 bar  
≤ 40 l/min / 370 bar

## KINSHOFER Gear Type Rotator with Flange up to 4500 kg Load Capacity (incl. Fittings)



KM 04 F



Type

KM 04 F

Load capacity  
(kg)

4500

Hole pattern  
of flange B  
(mm)

□ 140

Upper connection  
(Width C x Pin-Ø A)  
(mm)

84 x 30

Torque  
(Nm)

850

Moment of deflection  
max.  
(Nm)

3000

Self weight  
(kg)

26

KM 04 F140-30US\*

4500

□ 140

84 x 30

1000

8500

31

KM 04 F140-30V\*\*

4500

□ 140

84 x 30

850

3000

26

\* steel motor-head

\*\*additional vertical connection for the drive unit



KM 04 F



KM 04 F140-30US

Operating pressure:

20 - 37 MPa (200 - 370 bar)

Pump capacity:

25 - 60 l/min

Hydraulic couplings:

M 18 x 1,5

! Pump capacity/Operating pressure  
> 40 l/min / 200 bar  
≤ 40 l/min / 370 bar

## Product Range

## KINSHOFER Rotator Line

### KINSHOFER Gear Type Rotator with Shaft up to 6000 kg Load Capacity (incl. Fittings)

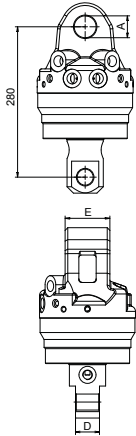

#### Type

**KM 06 S68-40**  
**KM 06 S69-40**

Load capacity	Shaft Ø D	Upper connection (Width E x Pin-Ø A)	Torque	Moment of deflection max.	Self weight
(kg)	(mm)	(mm)	(Nm)	(Nm)	(kg)
6000	68	84 x 40	1000	4500	32
6000	69	84 x 40	1000	4500	32

**Operating pressure:**  
**Pump capacity:**  
**Hydraulic couplings – in:**  
**Hydraulic couplings – out:**

**20 - 37 MPa (200 - 370 bar)**  
25 - 75 l/min  
G 1/2"   
M 18 x 1,5

!	Pump capacity/Operating pressure
	> 40 l/min / 200 bar
	≤ 40 l/min / 370 bar



### KINSHOFER Gear Type Rotator with Flange up to 6000 kg Load Capacity (incl. Fittings)

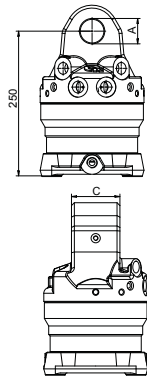

#### Type

**KM 06 F140-40**

Load capacity	Hole pattern of flange G	Upper connection (Width E x Pin-Ø A)	Torque	Moment of deflection max.	Self weight
(kg)	(mm)	(mm)	(Nm)	(Nm)	(kg)
6000	□ 140	84 x 40	1000	8500	34

**Operating pressure:**  
**Pump capacity:**  
**Hydraulic couplings – in:**  
**Hydraulic couplings – out:**

**20 - 37 MPa (200 - 370 bar)**  
25 - 75 l/min  
G 1/2"   
M 18 x 1,5

!	Pump capacity/Operating pressure
	> 40 l/min / 200 bar
	≤ 40 l/min / 370 bar



### KINSHOFER Gear Type Rotator with Flange and 4 Oil Ducts to operate 2 different Functions (incl. Fittings)

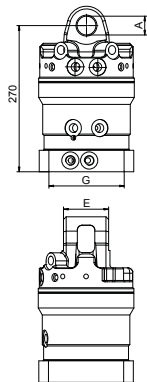

#### Type

**KM 04 F140-30-4**  
**KM 06 F173-35-4**  
**KM 10 F173-35/2-4**

Load capacity	Hole pattern of flange G	Upper connection (Width E x Pin-Ø A)	Torque	Moment of deflection max.	Self weight
(kg)	(mm)	(mm)	(Nm)	(Nm)	(kg)
4500	□ 140	84 x 30	850	3000	40
6000	Ø 173	81 x 35	1000	8500	45
10000	Ø 173	81 x 35	2000	12000	72

**Operating pressure:**  
**Pump capacity:**  
**Hydraulic couplings:**

**KM 04 F140-30-4** | **KM 06 F173-35-4** | **KM 10 F173-35/2-4**  
**20 - 37 MPa (200 - 370 bar)**  
25 - 50 l/min | 25 - 75 l/min | 26 - 75 l/min  
M 18 x 1,5 | G 1/2" | G 1/2" and G 3/4"



**KM 04 F140-30-4**

!	Pump capacity/Operating pressure
	> 40 l/min / 200 bar
	≤ 40 l/min / 370 bar

**KM 04 F140-30-4**

### KINSHOFER Gear Type Rotator with Flange for Logging (incl. Hose Guard and Fittings)

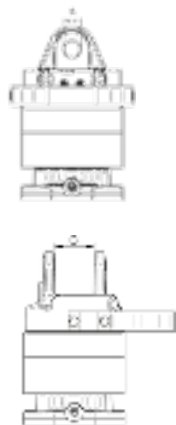

#### Type

**KM 06 F173-35**  
**KM 10 F173-35/1**  
**KM 10 F173-35/2**  
**KM 10 F173-45**  
**KM 10 F173-52**

Load capacity	Hole pattern of flange B	Upper connection (Width C x Pin-Ø A)	Torque	Moment of deflection max.	Self weight
(kg)	(mm)	(mm)	(Nm)	(Nm)	(kg)
6000	Ø 173	81 x 35	1000	8500	45
10000	Ø 173	81 x 35	2000	12000	62
10000	Ø 173	81 x 35	2000	12000	65
10000	Ø 173	100 x 45	2000	12000	68
10000	Ø 173	136 x 52,2	2000	12000	70

**Operating pressure:**  
**Pump capacity:**  
**Hydraulic couplings:**

**20 - 37 MPa (200 - 370 bar)**  
25 - 75 l/min  
G 1/2"

!	Pump capacity/Operating pressure
	> 40 l/min / 200 bar
	≤ 40 l/min / 370 bar



**KM 10 F173-35/1**

**KM 10 F173-35/1**

## KM 501 – Upper Suspension between Rotator and Crane

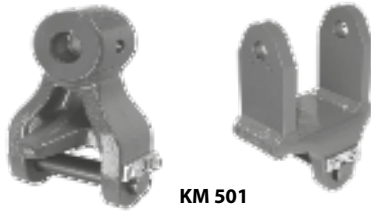

KM 501

An upper suspension is a cardan link between rotator and crane. It is available for all current makes and models of cranes. Please specify dimensions when ordering

Type	Load capacity (kg)	Self weight (approx. kg)
<b>KM 501 3000</b>	up to 3000	5
<b>KM 501 4500</b>	up to 4500	10
<b>KM 501 6000</b>	up to 6000	15
<b>KM 501 10000</b>	up to 10000	25

## KM 511 – Upper Suspension with Pendulum Damper between Rotator and Crane



KM 511

A pendulum damper reduces the horizontal swing of the attachment. It can also be retrofitted to an existing upper suspension

Type	Load capacity (kg)	Self weight (approx. kg)
<b>KM 511 4500</b>	up to 4500	15
<b>KM 511 6000</b>	up to 6000	20
<b>KM 511 10000</b>	up to 10000	30

## KM 206 – Hose Guard



The hose guard is a metal bow to be attached onto the rotator. It is designed to protect the hoses of the rotator from damage i.e. from protruding branches

	Self weight (approx. kg)
<b>KM 206</b> hose guard for the rotator	3

## KM 502 – Reduction Link between Rotator and Grapple



KM 502

A reduction link adapts a shaft type rotator to an attachment with a standard hole pattern for a flange

Type	Load capacity (kg)	Self weight (approx. kg)
<b>KM 502 3000</b>	up to 3000	2
<b>KM 502 4500</b>	up to 4500	3
<b>KM 502 6000</b>	up to 6000	4



KM 502-AD



KM 502-FL

## Accessories for Attaching Pallet Forks etc.



KM 460 03

Type	Description	Type of rotator	Weight (kg, approx.)
<b>KM 460 03 KM 03 S</b>	rigid suspension link with pin for all	KM 03	8
<b>KM 460 03 KM 04 S</b>	<b>KINSHOFER</b> shaft-type rotators	KM 04	10
<b>KM 460 08 KM 03 S</b>	rigid hook for all	KM 03	8
<b>KM 460 08 KM 04 S</b>	<b>KINSHOFER</b> shaft rotators	KM 04	9
<b>KM 460 04 KM 04 S</b>	non-rotating swinging hook for all	KM 04	12
<b>KM 460 04 KM 06 S</b>	<b>KINSHOFER</b> shaft rotators	KM 06	15
<b>KM 460 10</b>	non-rotating swinging hook for all <b>KINSHOFER</b> flange rotators	KM 10 F173 (KM 04 to KM 10)	25



KM 460 04



## KM 505 – Quick Change System for Shaft-Type Rotators

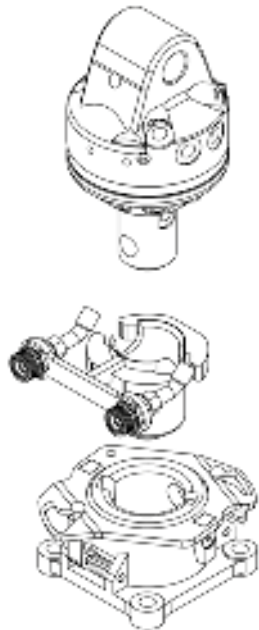

The quick change system enables an easy exchange between different attachments. The mechanical coupling and locking is achieved by the turning motion of the rotator. You simply disconnect quick couplings and disengage the locking device manually. Upper elements of the quick change system are available for all **KINSHOFER** shaft rotators. The KM 505 system can be used on most attachments which allows the versatility to quickly change the application with a minimum of down-time. Not suitable for heavy duty work.

Type	Description	Hole pattern of flange (mm)	Self weight (kg)
<b>KM 505</b>	complete, incl. hydraulic couplings (KM 204 01)	4x Ø18 / □ 140	12
<b>KM 505 01</b>	upper element fitted to rotator incl. 2 mobile parts		5
<b>KM 204 01</b>	mobile part of hydraulic quick coupling (2 pieces) for KM 505 01		
<b>KM 505 02</b>	lower element mounted onto attachment	4x Ø18 / □ 140	7
<b>KM 505 03</b>	rigid suspension link with non-rotating hook to connect to the KM 505 01		7
<b>KM 505 05</b>	distance ring between KM 505 and K M 461 universal fork		5



**KM 505 01**



**KM 505 02**



**KM 505 03**

## KM 505 HD – Heavy Duty Quick Change System for Shaft-Type Rotators

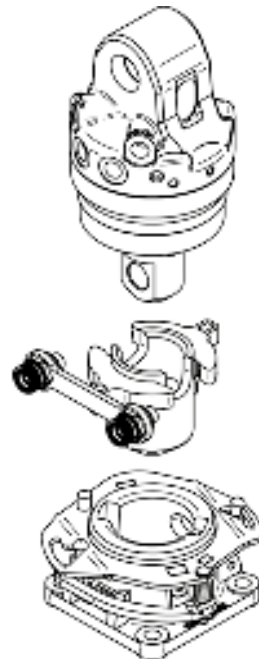

The quick change system enables an easy exchange between different attachments. The mechanical coupling and locking is achieved by the turning motion of the rotator. You simply disconnect quick couplings and disengage the locking device manually. Upper elements of the quick change system are available for all **KINSHOFER** shaft rotators. The KM 505 system can be used on most attachments which allows the versatility to quickly change the application with a minimum of down-time. For heavy duty works, we recommend the quick change system KM 505 HD, in combination with rotator KM 04 S68-30US or KM 06 S68-40.

Type	Description	Hole pattern of flange (mm)	Self weight (kg)
<b>KM 505 HD</b>	complete, incl. hydraulic couplings (KM 204 01)	4x Ø18 / □ 140	18
<b>KM 505 01 HD</b>	upper element HD fitted to rotator incl. 2 mobile parts		7
<b>KM 204 01</b>	mobile part of hydraulic quick coupling (2 pieces) for KM 505 01 HD		
<b>KM 505 02 HD</b>	lower element HD mounted onto attachment	4x Ø18 / □ 140	11
<b>KM 505 03 HD</b>	rigid suspension link with non-rotating hook to connect to the KM 505 01 HD		14
<b>KM 505 05</b>	distance ring between KM 505 HD and K M 461 universal fork		5



**KM 505 01 HD**



**KM 505 02 HD**



**KM 505 03 HD**

## KM 203 – Connecting Hoses & KM 204 – Hydraulic Quick Change Kit for Hoses



**KM 203 01**



**KM 204 01**

**KM 204 02**

Type	Description
<b>KM 203 01</b>	short connecting hoses between rotator and attachment with standard fittings M 18 x 1,5 (2 pieces)
<b>KM 203 03</b>	long connecting hoses between rotator and crane – please specify dimensions (4 pieces)

<b>KM 204 01</b>	mobile part of hydraulic quick coupling for hose (Ø 10 mm, 2 pieces)
<b>KM 204 02</b>	fixed part of hydraulic quick coupling for rotator (Ø 10 mm, 2 pieces)
<b>KM 204 03</b>	hydraulic quick change kit incl. mobile and fixed parts (2 pieces each) mounted with adapters to rotator